



100 CUSTOM LINE 100

THE NEW CUSTOM LINE MODEL'S SEXY, SPORTY STYLING COUPLED WITH BEAMY DIMENSIONS IS ATTRACTING OWNERS LOOKING FOR ACRES OF SPACE.

TEXT BY BILL ANDO

PHOTOGRAPHY BY SHAW McCUTCHEON / FERRETTI GROUP

*Doing away with the typical boat show or christening debut, Ferretti Group introduced the latest model in its Custom Line series to the yachting marketplace with a sense of deserved drama. The Wednesday night before the Fort Lauderdale International Boat Show opened, Ferretti held a press conference at its Fort Lauderdale office. Making the most of the facility's waterfront location, the Custom Line 100 surprised attendees, approaching from down the canal to the sounds of "She's So High" by Tal Bachman, a sprightly, hook-laden tune befitting the occasion (see video on the *ShowBoats* app).*

Although this was hull number two (the first was whisked away by her Croatian owner), this was the world premiere of the new model. And a fitting entrance it was, whetting appetites for the tours offered the next morning at the show.

"The new model was developed to satisfy the demands of those of our owners, including younger owners, seeking a more sporty design without forgoing the functional features and spacious areas of a wide-bodied yacht," says Marco Segato, Ferretti Custom Line brand manager. The CL 100 was not intended to replace the CL 97; instead the builder plans to retain this model for its clients who desire a more classic style.

This is the first time Custom Line has featured a wide-body style in its line of fiberglass, planing yachts, and as such, a new hull was developed specifically for the 100. She was a joint effort between Studio Zuccon International Project, Advanced Yacht Technology and the Ferretti Group's in-house naval research and design teams.

A few interesting design features were readily apparent as the CL 100 hove into view. The designers at Studio Zuccon International Project have replaced the traditional white fiberglass side bulkheads with floor-to-ceiling glass, allowing more light to enter the main deck and providing more expansive sightlines. There is also an abundance of glass in the full-beam main-deck master suite, and on the lower deck each

stateroom has a large picture window. In the aft queen-berth VIP staterooms, the windows function as headboards; in the forward guest cabins they bathe the cabins in light from the side.

Finally, the side of the superstructure is broken up by a style plate of sorts, three horizontal pieces standing off the superstructure that run at a diagonal connecting the flybridge with the aft end of the Portuguese bridge. While purely for aesthetics, they are visually effective to communicate sporty, speedy styling.

Another notable feature was on display at the boat show the next day—the starboard-side balcony accessed from the salon. An electrically controlled sliding glass door opens to this terrace over the sea and the gunwale drops down, which extends the view and increases the space for al fresco lounging.

This feature appealed to her American owner, who stepped up from a Ferretti 881 Raised Pilothouse. “We were attracted by the idea of having a lot of space and large areas to relax.”

The CL 100 offers deck space in spades. From the foredeck lounge and its creative use of the space on the coach roof’s forward edge, turning it into a lounge area (as well as twin sunpads on the coach roof itself), to the abundant al fresco space on the flybridge and the aft cockpit’s two-way settee that can be conformed for dining or sunning, the outdoor entertaining options are numerous.

The flybridge is huge, offering tender storage and a crane for launching, as well a large custom grill, wet bar and U-shaped dinette forward of the hot tub. A hard top provides protection; though not entirely hard, it has a soft midsection that folds back at the touch of a button to let in sun.

It’s not just the exterior spaces that seem plentiful. “As a result of the Portuguese bridge we have a very large master cabin, which



and the Caribbean, and the yacht’s power converter gives him the option of cruising in Europe in the summer season.

Concord Marine Electronics in Fort Lauderdale, Florida, developed and installed a custom navigation, communication, entertainment and security package for the owner, who had requested a high level of communication and entertainment capabilities. There are three redundant sources for Internet, and all TVs are high definition. The entertainment system can be controlled by the owner’s iPhone or iPad through a custom-designed application that also commands the lighting and drapes. He also can use his iPhone to see where the boat is at all times. A “geo-fence” security feature allows him to set a parameter around the yacht and be notified if it leaves the area.

The stylish Arcilena galley features a clever solution for accessing a technical space. Part of the counter slides to the side and a cabinet section can be pulled out to reveal a hidden door behind.

Accessed via a dedicated staircase from the galley, the crew quarters are forward on the lower deck and comprise three en suite cabins that sleep five and a galley/lounge. Aft on the lower deck is a garage that stores personal watercraft.

The engine room and mechanical space is entered from a doorway on the side of the aft superstructure into an engineer’s space then through a watertight door in the engine room. There is stand-up headroom and plenty of space surrounding the 2,639-hp MTU diesels to ease maintenance when the time arises.

Even in its infancy, the CL 100 has proven to be a successful model for Ferretti Custom Line—hull number eight is already in negotiation. Teaming up space with sportiness appears to be a winning combination. [SB ENHANCED DIGITAL CONTENT ON THE IPAD APP](#)

these pages
The yacht’s wide choice of outdoor spaces—such as the terrace off the main salon and the foredeck lounge—was a good part of the reason why the owner chose this new model. In addition, the main-deck master suite (far right) “adds precious extra space to relax on board,” says the owner.

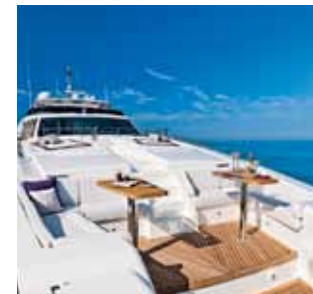

“A boat must be beautiful, but it must be a boat, not a house,” says Norberto Ferretti, Ferretti Group chairman, emphasizing the importance of practical storage solutions.

is unusual for this size of yacht,” says the owner. Upon entering the main-deck master suite there is a wardrobe immediately to port and a desk to starboard, then the room opens up into the sleeping chamber. The en suite and walk-in closet are typically across the forward section, but this owner opted instead for his-and-hers baths forward.

The suite is contemporary styled, as is the rest of the yacht. Designed around walnut veneers, lacquers, leathers and other textures, the yacht is as the owner desired.

“The main idea was to keep light and happy colors and also to have a simple, elegant feel,” he says. The interior has been decorated with furnishings from Italian design companies. The custom-made zebrano wood dining table and Poltrona Frau chairs stand out, complemented by leather-clad overheads and white onyx-paneled walls that are lit from behind.

“This kind of boat also gives us the possibility to stay longer on board and enjoy longer cruises,” says the owner. The yacht’s reasonable draft of six feet, six inches was another attractive feature to him, as he includes the shallow Bahamas on his list of intended cruising grounds. He also plans to visit New England, South Florida



BUILD: The total build time for a Custom Line 100 is 12 to 13 months from hull construction to delivery.

QUIET OPERATION: Motoring at 22 knots, reported sound level is only 66 decibels in the master and 62 decibels at the helm.

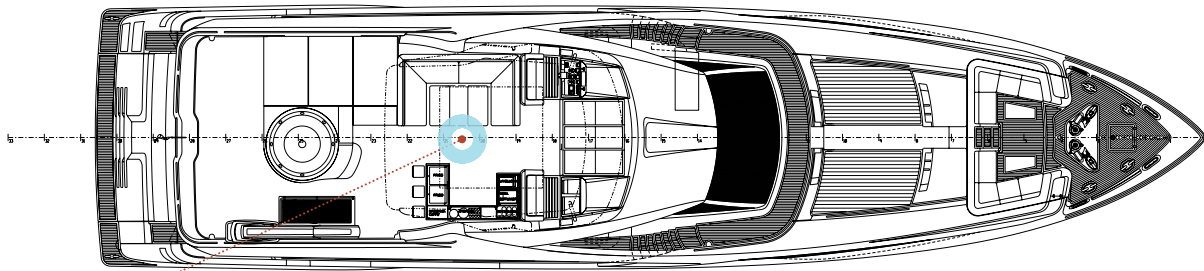

SHADE OR SUN: The hardtop (not shown) actually has a soft midsection that folds back at the touch of a button to let in sun.

FOREDECK: At the terminus of the Portuguese bridge walkway is a lounge area. A retractable awning is an option here.

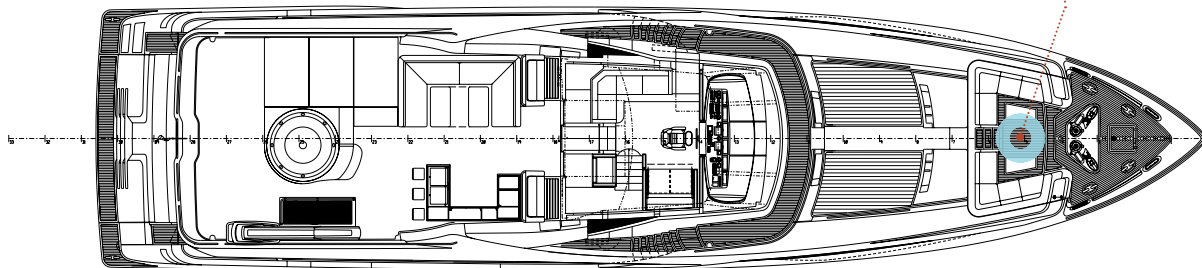

WALKWAYS: The wide side decks were a feature that appealed to the owner, who says they are larger than many competitors.

PRIVACY: Pocket doors on the port and starboard sides can close off the main and dining salons to the forward part of the vessel.

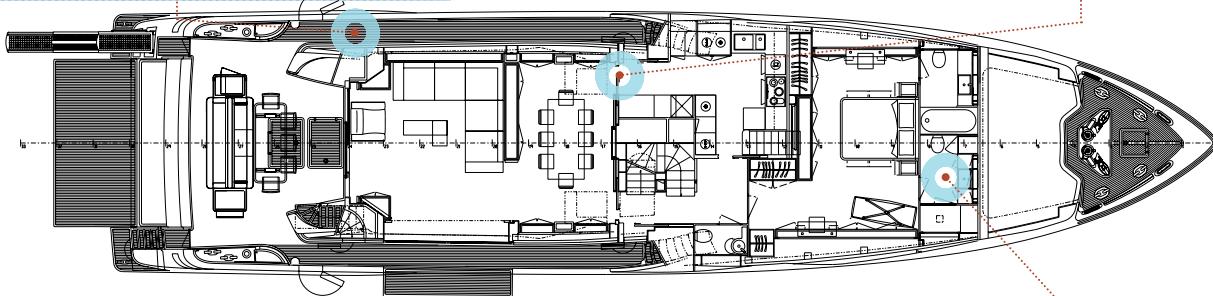

GARAGE: This space houses two large personal watercraft. A 16-foot Nautica tender stows aft on the top deck.

MASTER: Another layout option forward is a walk-in closet to port and a bath with two sinks to starboard instead of his-and-hers.

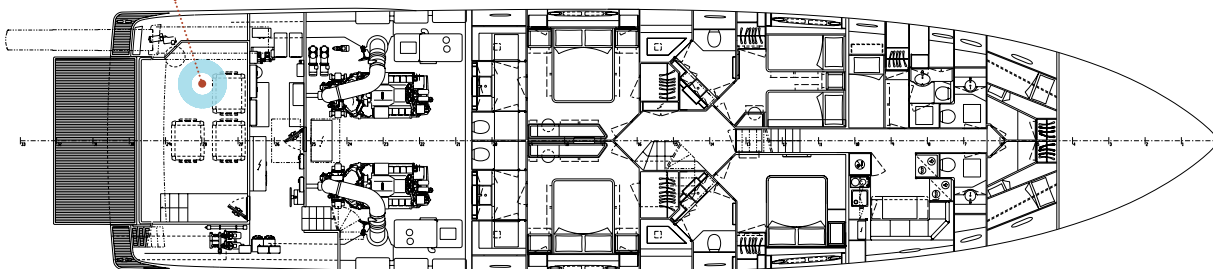

Specifications:

BUILDER: Ferretti Custom Line
Via Ansaldo, 5/7
Zona Industriale Villa Selva
47122 Forlì, Italy
Tel: +39 0543 787511
www.customline-yacht.com

LOA: 100' 5" (30.6m)
LWL: 84' (25.6m)
BEAM: 23' 9" (7.2m)
DRAFT (FULL LOAD): 6' 6" (2m)
DISPLACEMENT (FULL LOAD): 136 tons
POWER: 2 x 2,639-hp MTU 16V 2000 M94
SPEED (MAX/CRUISE): 27/24 knots

RANGE: 455 nm @ 24 knots (1,000 nm @ 12 knots economic range)
FUEL CAPACITY: 3,884 U.S. gallons
WATER CAPACITY: 793 U.S. gallons
GENERATORS: 2 x 55kW Kohler
STABILIZERS: ABT Trac hydraulic fins, 4 x Mitsubishi anti-rolling gyros
A/V EQUIPMENT: Concord Marine Electronics

OWNERS AND GUESTS/CREW: 10/5
CONSTRUCTION: Fiberglass
CLASSIFICATION: RINA, ✳ Mach, Y, unrestricted navigation
NAVAL ARCHITECTURE: Advanced Yacht Technology
EXTERIOR STYLING: Studio Zuccon Intl. Project
INTERIOR DESIGN: Studio Zuccon Intl. Project, Centro Stile Ferretti Group